

REV	ECO NO.	ECO TITLE	DATE
03	-----	DRAWING UPDATE	10/23/15

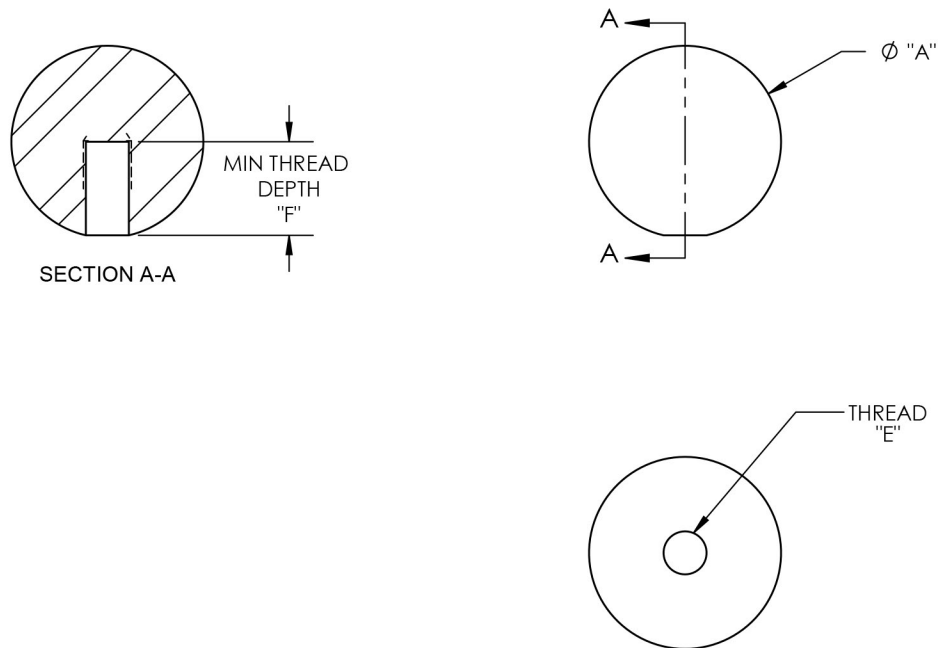

PART NUMBER	UNITS	DIAMETER "A"	THREAD "E"	MIN THREAD DEPTH "F"
250-B-T	in	0.250 ± 0.0001	#4-40	0.150
	mm	6.35 ± 0.003		3.81
312-B-T	in	0.313 ± 0.0001	#6-32	0.150
	mm	7.94 ± 0.003		3.81
375-B-T	in	0.375 ± 0.0001	#10-32	0.200
	mm	9.53 ± 0.003		5.08
500-B-T	in	0.500 ± 0.0001	1/4-20	0.250
	mm	12.70 ± 0.003		6.35
750-B-T	in	0.750 ± 0.0001	1/4-20	0.250
	mm	19.05 ± 0.003		6.35
100-B-T	in	1.000 ± 0.0001	1/4-20	0.250
	mm	25.40 ± 0.003		6.35

<p><b>PROPRIETARY INFORMATION</b></p> <p>THE INFORMATION CONTAINED IN THIS DRAWING IS THE SOLE PROPERTY OF MICRO SURFACE ENGR. INC. AND IS FURNISHED FOR INFORMATIONAL PURPOSES ONLY.</p> <p>© 2015 MICRO SURFACE ENGR. INC.</p>	<p>UNLESS OTHERWISE SPECIFIED:</p> <p>DIMENSIONS ARE IN INCHES</p> <p>TOLERANCES:                  ANGULAR: 1°                  TWO PLACE DECIMAL ±.01                  THREE PLACE DECIMAL ±.005</p> <p>INTERPRET GEOMETRIC TOLERANCING PER: ANSI Y14.5</p>	 <p><b>Bal-tec</b><sup>TM</sup>                  1550 E. SLAUSON AVE                  LOS ANGELES, CA 90011</p>	<p>TITLE                  THREADED BALL</p>		<p>NUMBER                  SEE TABLE</p>	<p>REV                  03</p>	
	<p>ENGINEER                  GENE GLEASON</p>		<p>DWN BY                  MGE</p>	<p>DATE DRAWN</p>	<p>SIZE                  A</p>	<p>SCALE                  1:1</p>	<p>PAGE                  1 OF 1</p>